

TOP OF STEPS VIEW

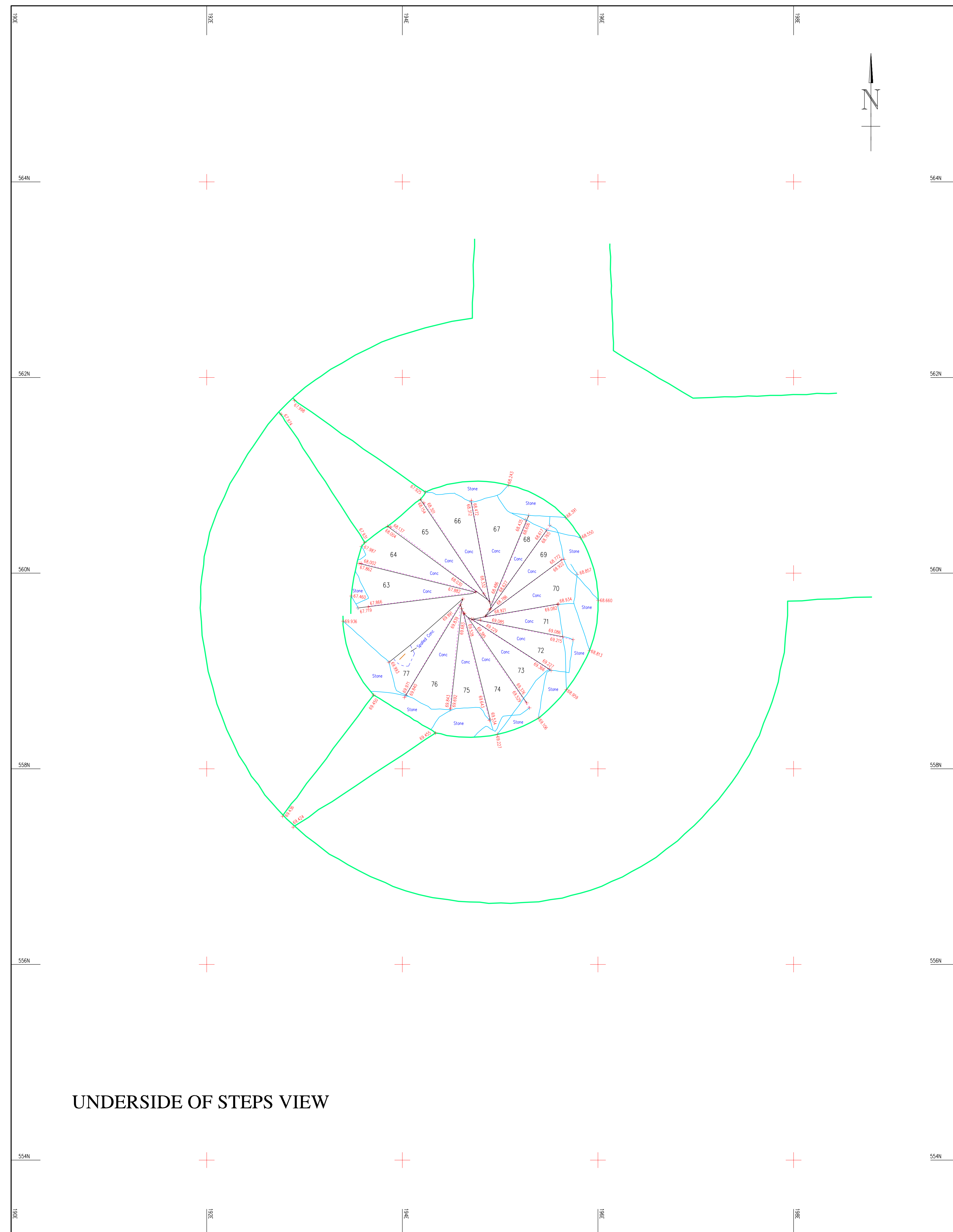

UNDERSIDE OF STEPS VIEW

**HARLECH CASTLE**  
**HARLECH**  
**GWYNEDD**

| Legend |  |
|--------|--|
|        | Top of step view   |
|        | Masonry Wall   |
|        | Change of step surface   |
|        | Top of step riser  |
|        | Base of step riser   |
|        | Damage to quoins stones  |
|        | Exposed reinforcing  |
|        | Hand rope ring - Position taken at point of fixing to wall due to wall verticality ring may not appear on wall line. |
|        | Underside of step view   |
|        | Masonry Wall   |
|        | Change of step surface   |
|        | Base of step riser   |
|        | Top of step riser  |
|        | Damage to quoins stones  |
|        | Exposed reinforcing  |

**HARLECH CASTLE**  
**GATEHOUSE SOUTH WEST TOWER**

Steps 63 - 77

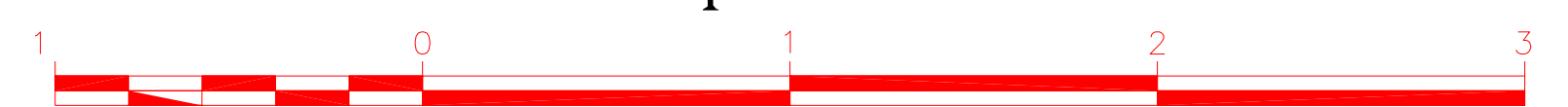

Site Plan

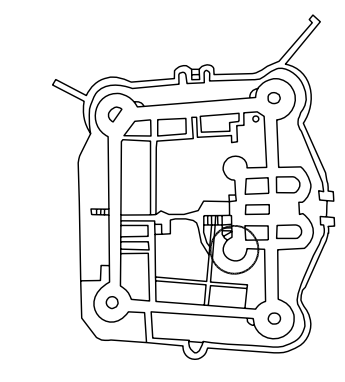

Site Bench Marks:  
 Datum - CS09 Masonry pin shown on  
 Dwg. S1490/78 & S1491/78 Supplied  
 by client value 58.530m AOD.

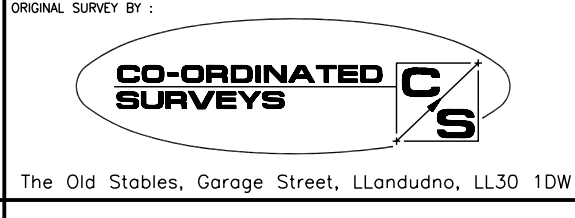

Sheet Information:  
 5 OF 10  
 Monument Number:  
 6220

Scale 1:20  
 Date October 2005

Checked CN  
 Dwg. No. 5618-5