

EXISTING SITE SECTION A-A (1:500)

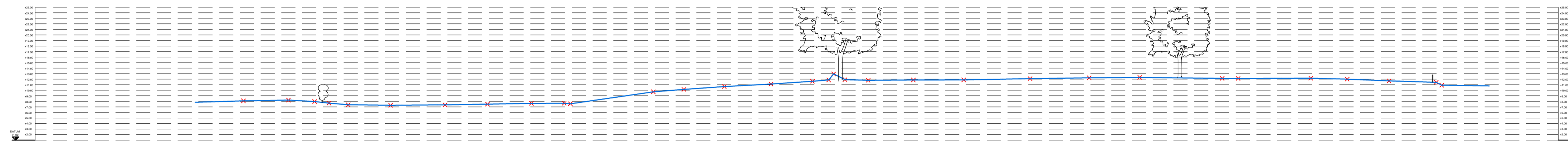

EXISTING SITE SECTION B-B (1:500)

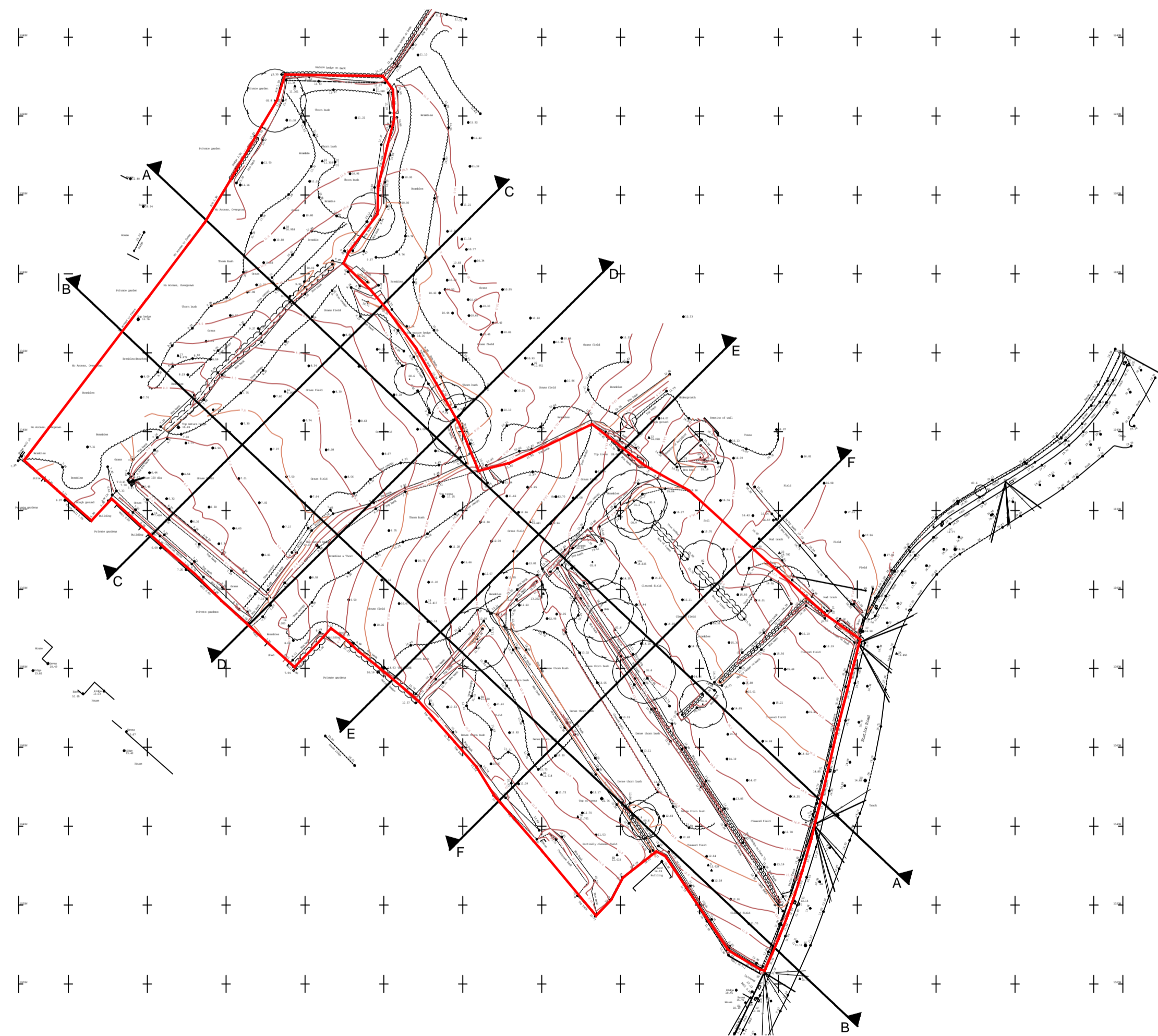

EXISTING TOPOGRAPHICAL SURVEY (1:1000)

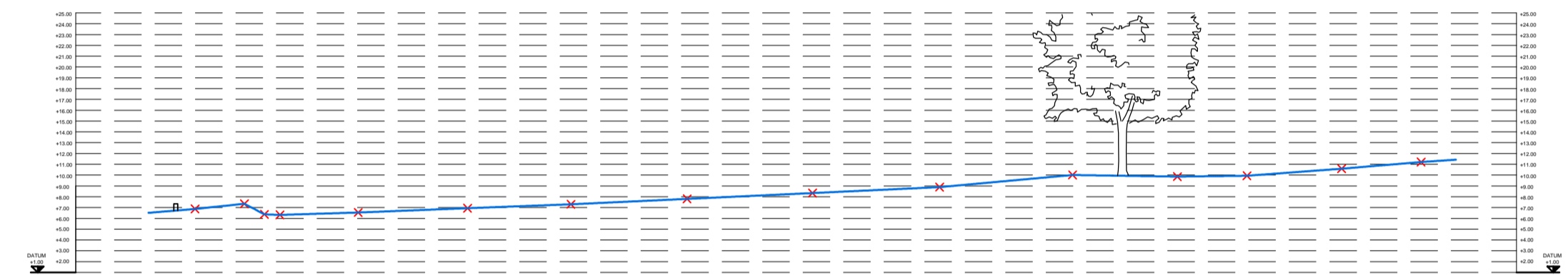

EXISTING SITE SECTION C-C (1:500)

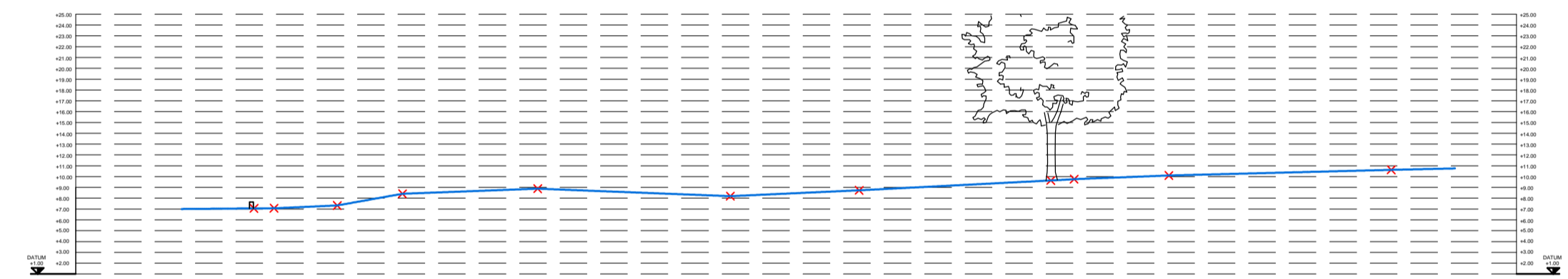

EXISTING SITE SECTION D-D (1:500)

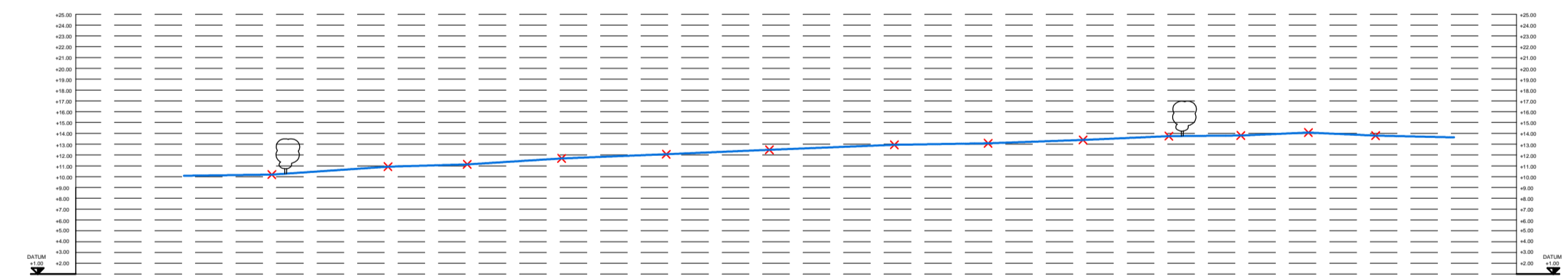

EXISTING SITE SECTION E-E (1:500)

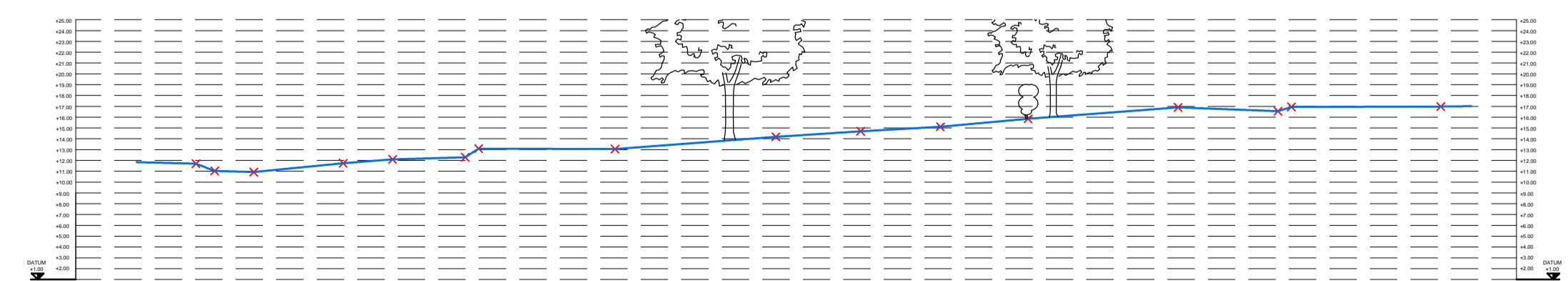

EXISTING SITE SECTION F-F (1:500)

Only use figured dimensions. Any discrepancies must be reported to LEWIS PARTNERSHIP LIMITED. The copyright of this drawing remains the property of LEWIS PARTNERSHIP LIMITED. Lewis Partnership Limited, registered in Wales, reg no. 3913005



13 Park Crescent LLANELLI Carmarthenshire SA15 3AE
01554 777998
enquiries@lewispartnership.co.uk
WWW.LEWISPARTNERSHIP.CO.UK



Rev	Amendments	Date	Ckd



Rev	Amendments	Date	Ckd

Project			
PROPOSED RESIDENTIAL DEVELOPMENT			
Location : GWINDWN MAWR, BYNEA			
Client : CARMARTHENSHIRE COUNTY COUNCIL			
Project Number	L / 1557	Drawing Number	02

Title		Date Drawn
EXISTING TOPOGRAPHICAL SURVEY AND SITE SECTIONS		JAN '13
Scale	Status	Date Checked
AS STATED	PRELIMINARY	29/01/13

Date Drawn	JAN '13
Date Checked	29/01/13