

Works to be done in the
Restoration and addition
to the Church at St. Andrew's
in the county of Montgomery
and Diocese of Bangor
according to the plans and
directions of the Architect
George Edmund Street Esq.
of 11 Cavendish Place
Cavendish Square London W.
Prefatory Clauses

The plans prepared here with
numbered ~~22 to 36~~ inclusive with the
elevations and descriptions thereon
are to be strictly adhered to as well
as such further drawings or instructions
as may from time to time be furnished
by the Architect for the more particular
detailed description of the Works.
The scale to which the drawings are
prepared is only to be followed when no
figured dimensions are given when however
figured dimensions are given they are
always to be followed in preference
to the scale upon the drawings, and
in all cases where details drawn
to a large scale are given they are
to be followed in preference to
drawings to a small scale.

dimensions for the several works, and is to make his new works fit the site or position assigned it or unite with any existing work with which it may have to be connected, as the case may be and no claim for extra works involved by inattention to this clause will be entertained by the Architect.

No moulded work or work involving the design of the Architect is to be put in hand without previous application to him for and supply by him of full sized detail drawings.

Tracings &c One complete set of tracings from the drawings will be furnished to the Contractor who will be required to make all further Copies he may require for the separate branches of the Works. On the completion of the Works the whole of the copies & tracings are to be returned to the Architect and they are not to be used for any other purpose than the execution of the Works herein mentioned.

Damage The Contractor will be required to keep free from damage the site of the Church surrounding premises and approaches to make good all damage that may occur from the execution of his contract & clear away all shops Offices Rubbish or other obstruction at the final conclusion thereof.

if deducted in whole a part to be restored
with 10 per cent additional.

All window tracery to be carefully set
out on a board for the Architects
correction before any of it is worked

Generally.

Materials

The material for the whole of the several
works throughout will be required to be
good and sound to the perfect satisfaction
of the Architect.

Workmanship

The workmanship for each trade is to
be of the strongest and best description
and is to proceed and be carried on at
such times and in such portions at a
time as the Architect may direct and
the whole is to be done to his complete

Special Satisfaction.

Tradesmen

The Iron window casements locks, hinges,
closing rings and all ornamental metal
work as likewise all carving in wood
and stone to be respectively executed at
contractors expense by tradesmen especially
selected by the Architect

Carving
+

Shoring Up

The contractor to most carefully shore up such
parts of the Old walls as require support
during the execution of the additions and to be
used with stone and rubble and all

Brasses &c. Any inscribed stones monumental slabs or
brasses and stones bearing same which
may be discovered on the removals of the
old floors, or which at present exist in
passages &c to be carefully taken up preserved
edges resquared or reduced in size and
relaid in such positions as shall be
directed by the Architect.

Antiquities Any ancient tiles, coins, or other
antiquities found are to be delivered to the
Incumbent.

Old Vaults &c Should any vaults or graves be found
under the present pavement or flooring
they are to be lowered or raised as necessary
to suit the proposed levels of new pavements
and made good wherever defective by
being vaulted over in 9" brickwork or
otherwise as may be considered necessary
and directed by the Architect and the
sum of £ 15 per to be included in
Contract for the work to be used as
directed and deducted is not required.

Note
Bodies If in making the necessary excavations
either within or without the Church any
bodies are found other graves are to be
dug for them in such positions as shall
be indicated by the Clergyman of the
Parish and the bodies or their remains
are to be carefully and reverently removed and

or other requisites and include for same
in amount of tender.

Graves Should any of the proposed slabs
or other walls happen to come upon
old graves, such graves are to be
filled up with concrete as will be
directed.

All necessary protection to be provided
to preserve from injuring during the works
and graves stones monuments or railing
round same now existing in the church
yard and any damage to be made good
completely.

The monumental tablets and List of
Benefactors or other tablets on the walls of
existing Church to be carefully taken down
from injury and refixed at the close of
the works where directed.

All damage which may arise to the
works during their progress from
whatever is to be made good by the
contractor at his own expense and the
work to be delivered up in a perfectly
sound and good condition at the conclusion
of the works.

Boarding Provide all fencing boarding or other
protection needfull for the building during
its reconstruction and remove same at

The workmen employed on the building
in the several branches of the Work
shall render all needful assistance in
carrying out the general Works before
named and any other such general
works as shall be found requisite
or from time to time be directed by the
Architect or by the Clerk of Works
as his deputy.

Pulling down &c

Generally. Take down the Walls at East end of
Chancel and stack old sound materials
for reuse and credit same and make
good all work disturbed thereby most
carefully preserve all the Stonework of
East window remove all useless materials
and debris arising therefrom.

Take up present stone and other savings
in church and credit same.

Take off remove and credit the present
slating from roofs

Take up the floors with curbs round the
same including joists sleepers &c under present
seating & credit same, Take down remove and
credit the Timber of present North aisle
roof such of the old Timber, as is sound
and approved may be re-used for the

Take down remove and credit the weather boarding of the Steeple save so far as it is perfectly sound.

Take down remove and credit the whole of the present seating in Church (excepting the ornamental oak panels or divisions.

Take down remove and credit the present gallery including seating and stairs leading to same and make good all work disturbed thereby as also the floor & partitions behind & under gallery.

Clear out and remove all rubbish or dirt which may have accumulated in the Belfry or Steeple

Take up and credit the present lead gutters to old roofs

Take up and credit the paving of Lower

Excavator

Set out work

The form and position of the new walls of extended chancel and of new buttresses to North Wall are to be carefully set out by the contractor subject to the direction of the Architect or Clerk of Works.

Excavate

The earth is to be excavated to a sufficient depth to receive the foundations of the walls, Heating Chamber, Drains &c as shown in the sections and to be removed & spread or levelled where directed in the Church Yard or elsewhere.

Concrete.

Concrete to be composed of one part of fresh well burnt ground stone lime & six parts of clean coarse gravel to be well mixed together in a dry state & water in due proportions afterwards added & thrown into the Trenches or Spaces from a height from at least 8 feet. The Concrete for the pavings to be composed as above described but with fine instead of coarse gravel well beaten & solidified.

Drains

Lay the several 4" & 6" glazed stoneware socket jointed drain pipes as shown on Plans from the rain spouts or to Drain Heating Chamber or laid to proper falls in well tempered clay and jointed in cement with all needful bends junctions &c. ^{provide} 50ft of 6" drain pipes beyond that shown on Plans to convey water outside boundary where end of pipes is to finish with brick aprons Doultton's stoneware Cesspools 9" x 9" in clear and 14" deep covered with 2 1/2" tooled York stones covers with 4" cast iron bell trap inserted therein to be provided one in centre of Heating Chamber and one at foot of Heating Chamber steps and another but with 3" cover where directed by the Architect

Provide a small dry well to receive contents of Piscina as may be directed also a well 2 feet clear diameter and 3 feet deep carefully staired with rough stone or hard bricks and with hard stone cover to same complete under font.

Provide any strutting and planking necessary for excavations.

Leave site clear & the church yard in perfectly good order.

Bricklayer

Brick Keeper
Walls

The Keeper walls under boarded floors of chancel stall to be built with hard bricks set in mortar one brick thick with proper footings as also walls to receive chancel steps and steps at side of vestry and organ chamber.

Arch over
Heating Chamber

Turn one brick arch in cement over Heating Chamber clean off soffite point up & twice limewhite same

Pavings

The floor of Heating Chamber to be paved with brick on edge paving in cement on a bed of concrete 4" thick.

The tile floors tinted light red on plans except otherwise described, are to be laid with Goddard's best thin 4 $\frac{1}{4}$ " plain red, black and buff tiles in patterns to design of Architect.

The chancel pavements to be executed as shown on detail drawing in Goddard's tiles mixed with Forest of Dean stone squared & robbed inserted therein. The stone to be laid in

The tiles are to be set in Portland cement except as hereafter described upon a bed of concrete 6" thick floated over to a perfectly level surface with Portland cement and clean sharp sand in equal proportions except to tower where concrete is to be 1: 9" thick as shown.

N.B. No cement to be used with tiles near stone or marble pavements steps or walls, and should any damage by inattention to this arise to marble or stone by stains or otherwise the same is to be taken up and relaid with new at contractor's expense.

The levels under concrete beds for tile paving of chancel or to be made up with hard dry rubbish spread in layers and well rammed.

Note

Provide the sum of £30 per cent for forming air flues and setting Heating apparatus over and above works herein specified.

Heating Chamber

Excavate for the foundations of all walls for the heating chamber to be formed under E. end of aisle and for the necessary drains for same, the draining to be executed as already specified. All the work underground to be of sound hard well burnt Stock bricks, and the interior of the chamber finished with a neat struck joint to be limewhited at finish steps to be of hard brick on edge with 3" hard stone heads, & 2 1/2 risers, let into stone wing wall 10" thick as top with 14" brickwork & footings below steps and backing bonded with stone face to proper thickness. + Old walls to be underpinned in brick in cement faced, when visible with stone. Floor of chamber to be paved with brick on edge grouted in sand & laid on concrete as before. Construct opening of flue from chamber and carry up flue as shown

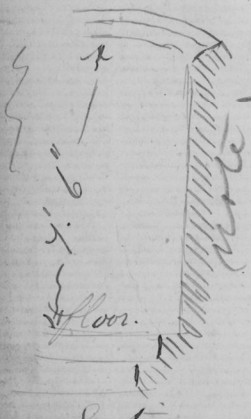
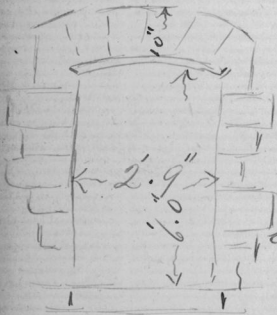

Opening for same being made with care.
Chimney flue 12' 0" high above eaves for which
the contractor is to allow in his contract the
sum of £16.

Dorway to be formed to the Chamber with stone
joints and arch. The Walls of Chamber to be
built of brick in cement & filled in solidly at
back to be covered with a double brick arch of two
rims of 4" 1/2 work.

Waller

Walling
Stone

The stone for all new walling to be similar to
the best quality of that used in the Old Work, selected
hard and even in quality and in sizes suitable for the
particular character of the work required.

Walling

The walling to be constructed in the strongest
possible manner to have ample bond or through
stone to be well flushed up with mortar and
to tie in strongly with masonry all interstices within
the walling to be carefully filled up with smaller
pieces of stone & mortar so as to leave no cavities
and to be carried up at a uniform height.

Footings

The footings to be executed with large flat even
bedded stones well bonded and flushed with good
mortar.

Mortar

The stones to be set in strong sound well tempered
mortar composed of one part fresh and well slaked
stone lime to two parts of clean drift of river sand
or if pit sand be used to be thoroughly washed to
free it entirely from earthy particles.

Facings

The external face of the walls to be built with
stone from Quarry at Penstrouse or other approved
quarry set in mortar and finished with a fine
mortar joint to be well bonded built in random
courses with stone always on its quarry beds the
beds of it being built in a regular manner

whole thickness of stone a specimen of facing to be prepared for approval before the work is proceeded with and the whole to be examined at the close of the work and all defective pointing made good. The walling to be made to agree generally with the character of the best of the Old Walling in the Church. The mortar not to be colored.

The best of stones arising from pulling down old East Wall to be re-used for facing the new chancel with its weather face outside.

Discharging
Arches

Contractor is to turn rough discharging arches in heart of Walls over all openings wherever practicable and neatly finished discharging arches of Walling stone over the external Arches.

Bond New to
old Work

Cut chase and parget for and bond new to old work and well grout same when the work is carried up. Level and prepare old walls to receive new where same are raised up on

Damp
Course.
Note

Two courses of large stout slates set between layers of Portland cement to be laid through the new wall (except sloper walls under stone steps) at the ground line properly capped to prevent the damp rising.

not done in
North wall
& Rectory
Line White.

Twice lime white and keep the Walls of Heating Chamber fair.

Smoke flue.

The smoke from Heating Chamber to be conveyed to Chimney shaft by 9" unglazed fire clay flue pipes.

Ventilation
under
floors

The underside of wood floors to chancel stalls to be properly ventilated by carrying 6" earthenware drain pipes across passages and provide No 2 air stones 14" x 9" and 6" thick as sketch

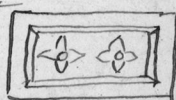
to detail including copper wire  perforated guards fixed at back of same with proper aperture in wall formed and rendered in cement.

Beam filling. Execute at all eaves of roof beam filling in mortar as required or shown on Drawings. cut to full slope of roof.

The Walls to be covered and properly protected from time to time in case of severe rains and frosts or other stoppings of Works.

The new walls are coloured red on plan
The old walls being coloured grey

MASON

Dressed
Masonry

The whole of the stones for the dressed masonry quoins, plinth, courses, string, copings, cabsels, windows, doorways &c other similar work to be from the Cefn Quarry all to be selected of the best quality the quarry will afford free from sand or clay holes vents &c other defects to be laid on its natural quarry bed in good strong fine mortar finished with a fine boasted surface approved by the Architect and to be well bonded together and secured with all necessary slate dowels 2" square and 4" long run with cement, iron dowels lead, or stone plugs, galvanized iron or copper cramps &c complete as directed by the Architect

Workmanship

The whole of the masonry to be worked in every part most carefully & strictly in accordance with the details supplied & the directions given by the Architect from time to time, All quoins arch stones sills and other dressings to bed fully through their depth with square leading joints.

The stone for masonry window sills and similar details to be selected of the very best cleanest & soundest of the stone and to be worked with especial care to be jointed as shewn by details & always on the true radius line of the curves intersected whether of main tracery lines or cusping lines.

Bedding
Sills

The sills of windows to be bedded hollow between the masonry and jambs in setting and pointed up under at the close of the works.

Bedding
Piers &c

The Piers responds and other parts of the work subject to much pressure to be very evenly bedded with not too close a joint to admit of fair settlement and to prevent flush at the edges of joints

Quoins

The external quoins to angles of Buttresses and walls to be cut square on plan (not one out of another) well bonded to average 12" x 12" on bed and to range with the courses in the facing.

Strings
Labels
Grooves &c

All molded and splayed strings & labels to average 11" on bed including projection. Cut necessary grooves in stone for Quarry glazing and point up same in both sides in cement also grooves for lead flashing and turn same in.

Carving

Let in ends of saddle bars and cement same. The stone carving is to be executed by a carver specially appointed or approved by the Architect and Contractor to provide all necessary scaffolding making good mouldings &c up to carving and cleaning down after setting.

Cross stones

Note

executed as shown on drawings & crosses to be secured to saddle stones by copper dowels $3/4$ " square & 18" long let in and run with cement.

Steps &c generally

The whole of the steps except where otherwise described to be executed in Hard Forest of Dean or other approved hard stone 4" thick rubbed face and edge and rebated for tiles and of the widths shown on the drawings.

Steps &c to Heating Chamber

The Heating Chamber to have 15' x 3' York stone tooled top and face steps & window to same with brick on edge risers in cement with a dwarf wall at top 3' 0" high finished with a double chamfered coping 12" x 6".

Chancel steps

The Chancel to have yellow Mansfield stone rubbed face edge chamfered and rebated steps  6" high and of the width shown on detail Drawing.

Font.



The old Font is to be carefully taken down cleaned and refixed with new shaft and moulded base making good all defective or deficient parts with new and new Forest of Dean stone rubbed steps under.

Note

font of the size shown on plans & 8" high.

Pulpit

The present pulpit to be removed a new one made as hereafter described and the sum of £35-0-0 to be provided for same.

Note

Sedilia & Piscina

Execute the Sedilia and Piscina as shown on Drawing No. the Piscina to have $3/4$ " lead pipe with tatted and dressed end from same to a small dry well.

Case up and properly protect masonry clean same down and leave all perfect at completion.

Restoration &c

Note The Contractor is to clean in the most careful manner the Arches with columns supporting them also the caps and bases of columns and respond piers to have arcade every stone retained in its old place so far as same is sound, all defective or deficient stones being reinstated with new, clean masonry free from plastering colour or other defacement with potash or Manchester card, or other process as may be directed, but without the use (on old face of stones) of Mason's chisel only so far as to repair without defacing the original masonry and leave the whole perfect and complete to the satisfaction of the Architect.

Insert necessary centring and shore up arches before taking down walls of Chancel. Open out and take down in the most careful manner the present chancel & Southern windows, mark all the stones for re-use &c clean masonry &c and make good defective or deficient masonry with new and reset same as before described.

Windows of } Carefully examine and restore the windows
St. Asple } of St. Asple removing all plaster & other
defacement &c and restate with new
all decayed masonry &c as before described
and put new stones mullions where the
Old are defective as shewn on
North Elevation

Buttresses }
N. Aisle }

Build new stone inside arch to window
of North Aisle and to other old windows
Carefully take down the existing buttresses
to N. Aisle cutting out present and inserting
new buttresses with wrought stone weatherings
quoins &c as shown, on proper foundations.

Font

Clean off plastering as before described
from face of old walls and point up same
wherever required.

Take carefully down present font thoroughly
clean same and repair as directed
making good all defective or deficient parts
with new.

Allow a sum
of £30 to be
spent on works
in Tower over and
above what is
specified

Clean off plastering from external
walls (except steeple) externally thoroughly
clean the stonework rake out joints of walling
and neatly point up same with a sloping
mortar joint and make good any settlements
that may be discovered.

East
Window }

In rebuilding the East window provide
for new tracery wrought with cusping in
place of the old tracery from which all
the cusps have been cut (see detail).

Restore all the south windows putting
new cusped tracery where the old tracery
has no cusps, and where wooden windows
mullions &c have been introduced putting new
windows corresponding in style with the old
ones in the same wall.

Bond all new stonework properly to old and
leave all complete

Thoroughly clean the inside of the Tower walls up to
& including groming and point the same very neatly
with good mortar

Plaster

S. Aisle }

Cover the whole of the roof with Whitland
slates or other approved Green Ladies slates

close with double eaves and to be left ^{clean} and perfect at completion.

Ridges

The ridges to be covered with red crested ridge tiles made by Cooper of Maidenhead as shown on Drawings, to be accurately fitted to slope of roof and properly bedded and jointed in cement.

All the old slating to be taken off by the Contractor.

Carpenter & Joiner

All the timber except where otherwise described to be of the best quality of Memel or Riga No American Swedish or Scotch timber to be used in any part of the building.

The timber where specified to be of English Oak or Riga wainscoat to be of the best quality.

Deals and Battens specified are to be the best Yellow Christiania Petersburg or Oregon.

All the Timber and Deals to be perfectly sound and free from sap shakes large or loose knots and all other defects and well seasoned.

Provide all requisite centring trussing pieces ribs strutting &c and ease strike & remove same when directed.

All wood joints are to be of the best heart of oak.

All Timbers to be sawn die square and to hold the full finished sizes

All carvings to be executed by a Carver approved by the Architect

No joists or rafters unless definitely figured to the contrary are to be more than 12" apart in the clear.

The whole of the new roofs of N Aisle and Eastern Enlargement are to be framed wrought & jointed with Oak joints according to the drawings and of the sizes figured thereon.

The Chancel Roof being an exact copy of the Old Nave roof in all particulars

All plates are to be in long lengths halved and oak jointed together and to return 4 ft into the gables the outside and inside plates are to be connected with framed cross pieces $4\frac{1}{2} \times 4\frac{1}{2}$ at intervals of 6 ft apart.

All timber going into the gables are to have oak templates about 3 ft long 5×4 and the feet of all new principal rafters to rest on oak templates about 5 ft long 9×6 or 12×6 as required.

The roof of N. Aisle to be executed in fir as shown on drawing N^o 6 and timbers to be of the scantlings figured thereon.

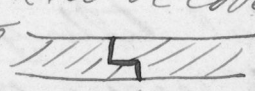
The whole of the roof of Nave, Chancel, North Aisle & Porch. to be covered with 1" wrought deal rebate jointed  boarding in 5" widths and to have Croggan's patent dry non-inflammable roofing felt laid thereon well lapped at the joints & nailed & on the felt place $3\frac{1}{4} \times 2$ deal Battening

The stone roof to be repaired with new Oak wherever the old is decayed. All white-wash or paint and dirt to be removed from the old timbers. All oak used in repairs to be wrought to correspond exactly in size & with the old and properly tenoned, pinned and scarfed to old. The contractor to execute all repairs at the rate of 8/6 per foot for oak used in common rafters and 4/- per foot for oak used in repairs of moulded work & to provide oak where required for carving but no to do any carving.

Price to be stated in tender

Carving note

A sum of forty pounds to be included in contract for the carving to be paid as directed by the Architect and if not expended to be deducted.

The extension of the roof Eastward or New Chancel to be executed in exact correspondence with the old roof over the nave in all respects in best quality of English Oak, and in this portion of the work the Contractor is to execute all the carved and moulded work the same as the old and to employ a competent carver approved or recommended by the architect

Carving

All roofs to have wrought feather edge eaves boards 11" wide $1\frac{3}{4} \times 2\frac{1}{2}$ " thick at all dripping eaves. The gutter at back of Chimney shaft to be laid with $1\frac{1}{4}$ " yellow gutter board and framed bearers 3×2 ".

Fix deal tilling fellets or boarding at sides of gutter to receive the lead also up all gables. Perform all planing chamfering stopping & metring in solid necessary throughout the roofs

Lower roof } All the decayed or defective timbers to the tower
to be replaced by new carefully framed and
pinned together as to the old work. The windows
which have been formed in upper part to be
retained but to be filled with new $1\frac{1}{2}$ " oak
luffer boards properly let into grooves.

Bell frame } The timbers which support the bells to be
examined and renewed if decayed, and the bell
frames wheels ropes &c to be all repaired where
required and left in perfect working condition.

Floors. The floors under chancel slatts to be 1" oak
wrought ploughed and tongued floor in narrow
widths on joists and 5×4 " oak sleepers
as on detail.

Doors. All the doors to be new to be of $1\frac{1}{2}$ " English
Oak framing in small panels mitred chamfered
or solid covered with 1" oak wrought ploughed
tongued and jointed both sides boarding
in 5" width edge nailed with wrought
nails. The door to Heating Chamber
to have $1\frac{1}{2}$ " deal framing covered with 1" oak
boarding as above described. The door to
porch and external door of tower to be hung
folding to 3×4 " rebated and chamfered
frames allow the sum of £30 p e for hinges
locks bolts & fastenings to doors of church
generally to be executed by a Smith appointed
by the Architect and which sums are exclusive
of carriage and fixing and Contractor to provide
for carriage and fixing in addition.

Lower tower } Provide $1\frac{1}{4}$ " Oak wrought ploughed (2 wrought sides) and
tongued and properly ledged courses fixed on splay to

Note

1 1/4 deal shutter ventilators about 3ft x 1ft
grooved tongued and ledged in & including
proper rebated frames 3" x 2" boxed in at angles
to prevent admission of air when closed and
filled with langes cords eyes pulling double
books &c complete to open and close same

Porch }
roof }

The Porch to have
a new fir roof of
the section here shown all
the rafters to be framed
in the same way and
boarded &c as other roof

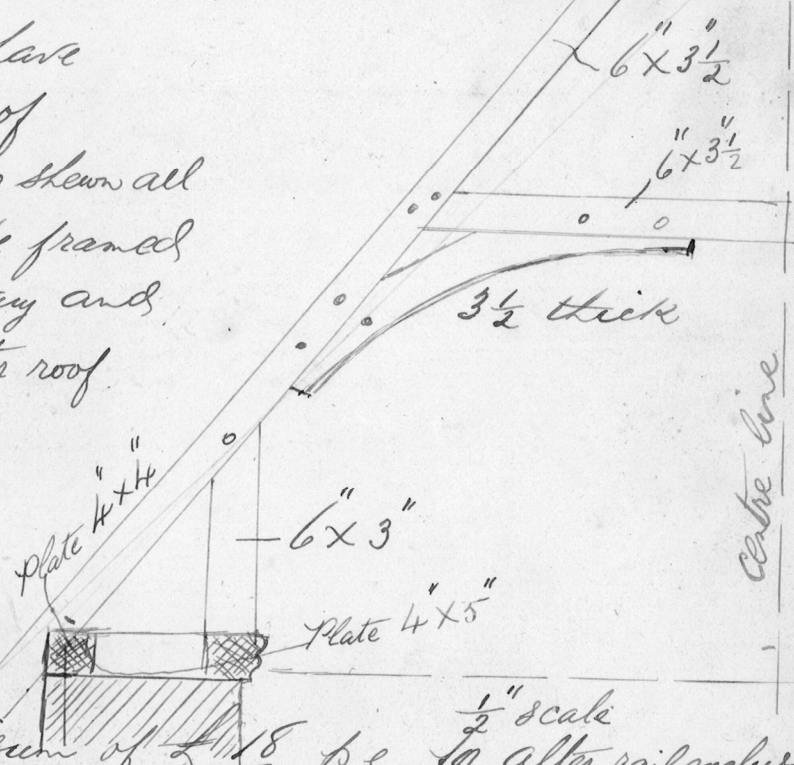

Note

Provide the sum of £18 p.e for alter rail exclusive of
fixing & contractor to allow for carriage & fixing in addition

Altar

The Altar to be constructed in best clean
Kiga Maenscot as shown on drawing framed as
follows. top with molded edge panelled
front and ends the panels with linen panelled
heads. plinth 3" thick molded & mitred with
all wrought and framed backings on bearers
requisite.

Note

All the oak in the present seats and
pews to be carefully taken down and
stowed away and to be at the disposal
of the Vicar, to be used as he may
direct

Journal of Mill

Eaves gutters Provide and fix ^{1/2} 5" semicircular eaves gutter to all overhanging eaves on proper wrought iron brackets screwed to feet of rafters to be properly cemented and secured together at the joints and fixed before the slating is commenced with proper stoppered ends, outlets &c

Stack
Pipes

Provide 4" cylindrical cast iron rain-water pipes where shown or required with ornamental bands fix to wall with cone headed nails each to have cast iron moulded leads of the P.C. value of 15/ each exclusive of fixing and fix same complete.

Note

Provide all necessary bends and shoes.

Provide and fix copper wire gratings over outlets of eaves gutters and in leads of R. W. pipes.

Saddle
Bars &c

All the lead lights to the several windows are to have wrought iron saddle bars $5/8 \times 5/8$ with an eye worked on for stanchion. The stanchions to be $3/4 \times 3/4$ with fleur-de-lys terminations and are to be carefully let into the stonework and cemented

Provide do 15. wrought iron sliding or hung casements including all lines hinges & fastenings as will be directed of the P.C. value of 30/- each exclusive of carriage and fixing and allow for same in addition.

Note

Provide a sum of £12 for Vane & cross or steeple.

Plasterer

The new walls and those pulled down and rebuilt to be rendered floated set & finished with a fair sanded surface not jointed internally.

Hack the plastering off old walls inside & out and make good any settlements which may be discovered in the Walling and render float & finish with a fine sanded surface (not jointed)

Contractor to cut out with plain tiles and cement where necessary to bring walls to an even surface.

Plumber

Note Provide and fix in all window sills at bottom of quarry glazing 4" lead condensation gutter 4" gut neatly dressed to rebate. Put proper lead 5" flashing over roof against Tower.

Glazier

The whole of the windows to be glazed with 21° Cathedral glass in two selected tints in lead lights the quarries about $3\frac{1}{2}$ square & $3 \times 3\frac{1}{2}$ diamonds with bands & margins. The lead to be narrow and very strong in the core approved by the Architect before being used to be cemented in on both sides and to be tied with strong copper wire to the iron saddle bars. The present glazing in the Old windows to be taken out by contractor and to become his property.

Leave all glass clean and perfect at completion.

Painter

The whole of the iron work to be painted four times in oil 2 coats before and two after fixing the wrought iron to be treated with professor Parff's process for preventing rust.

The new boarding roof timbers &c of the whole of the Roofs also ceiling over porch to be wrought where exposed to view prepared for staining and to have a coat of staining to corresponding color. with old oak timber but not to be varnished

Contractor to state additional expense of taking down and rebuilding the whole of the N. Wall of N. Aisle carrying down the foundations 3ft below floor line with proper footings

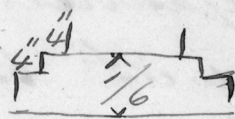

Note The church will be given up to the builder on a date fixed and he will be required to complete the works within seven months of that day

He must prepare his new roofs and stonework before commencing in the building.

Chancel
Stalls

The chancel stalls are to be constructed in the best well seasoned Riga wainscot framed and made in strict accordance with the detail drawings.

Chancel
Screens
Note

The chancel and vestry screens to be constructed in the best clean and well seasoned Riga wainscot and to allow the sum of £9 p.c.

Note

This screen
to be separately
estimated for

for ironmongery including hinges locks and fastenings which sum is exclusive of carriage and fixing and Contractor to pay cost of carriage and fix same in addition

Nave
seating

The whole of the seating in the nave and aisles to be executed in accordance with the detail drawings in the best English Oak well seasoned and carefully selected

addenda to Specification

Drains

Drains to be laid on each side of church & to discharge the North side at the most convenient outlet.

Note

Pavings

Vestry to be paved with tiles.

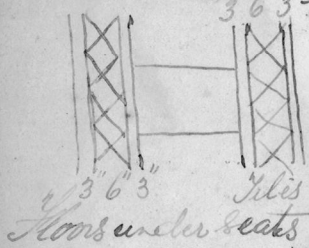

The new stone floors of passage &c to be of hard rubbed 2 1/2 York or other approved stone with margin of tiles all laid in lias mortar on 4\"

To be White's solid yellow deal Burnt & glazed Block flooring 1 1/2 thick quality C pattern No 4 to be provided and laid by the maker. In Gros Gregory Station Works Clapham Junction S.W. to be in concrete 6 in thick with floated upper surface for same.

Lower Arch

To be repaired where it has been cut away or damaged.

Porch

The outer semicircular headed doorway is not to be altered

Note

The stonework of doorway inside to be cleaned no new outer work

Tower

Tower roof not to be beam filled.

Seating

Take down & credit seating except ornamental work.

The Contractor has not got to remove the Organ.

Chairs not to be included in tender.

Ridge tiles to be simple pattern No 16 cooper's list

Credit pulpit & reading desk.

The windows for louver boarding are those in the wood framework at top.

The Gates for nave screen are not to be omitted in tender.

Seat for Organist not to be included in tender.

Children's seats same as others but 1/6 smaller in all dimensions.

Seats & screens to be left clean from plane not wax polished.

Nothing to be done to staircase to belfry except putting door at foot

No stone coping to N. Aisle roof.

The cost of the restorations & repairs of the roofs &c to be included in the contract with the exception of the common rafters and a price per foot to be given for these so that they may be replaced where required with new and measured.

Allow £ 3 for window to Heating Chamber.

Do £ 8 for repair of window looking on to ring's floor